

Spencer Park Survey

Improving both Spencer Parks to provide more play/activity opportunities for all ages living near the park has been a priority of North Earlsdon Neighbourhood Association (NENA) since its inception.

The Friends of Spencer Park and Recreation Ground group helped by NENA, would very much like to find out what you and your family would like to see in both the larger Spencer Recreation Ground and Spencer Park. The results of this informal consultation will be used to guide the group when looking for funding sources to hopefully make your ideas a reality and give the group an idea of the amount and type of funding they need to apply for. Any ideas will need to feed into the Park Service at the City Council to make sure they are realistic, robust, affordable and sustainable.

The Friends group would like to see improvements in the Park. They are working towards putting in a funding bid to be able to use the area next to the tennis courts in the park to provide a play area for young children. This would be the beginnings of a plan for developing the park in the future. The second stage of the development plan would be to try and get funding to develop the Recreation Ground.

We are looking for your ideas on the development of both Spencer Park and Recreation Ground.



An example of a multi use games or sports area.

This could be an idea for the recreation ground please see question 8.

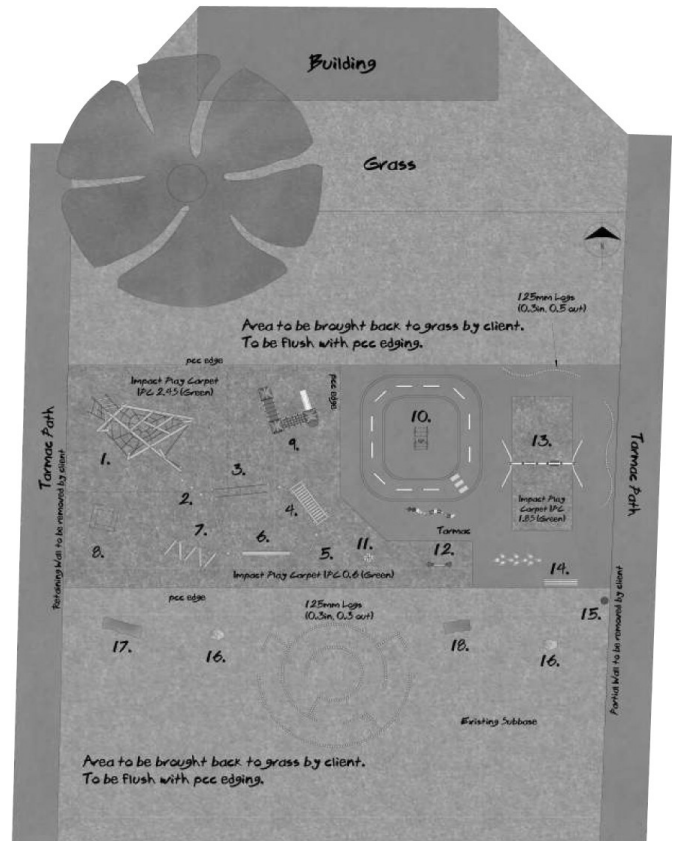

An example of a plan of a children's play area

Key: 1,2,3 and 4 climbing structures
5,6,7 and 17 logs
8 mini trampoline
9 house and slide
10 car
11 spinner
12 sea saw

Please return the survey to the Echo box in Earlsdon Library or to the office in Spencer Park by Friday 17 May 2013.

There will be a prize draw for completed surveys, for a £25 gift voucher, if you wish to be included in this draw please put your contact details on page 4 of the survey.

Spencer Park (Small Park)

We would like to develop the old tennis court next to the Pavilion into a play facility for under eights and to provide a meeting space for parents of younger children.

1. Do you already use small Spencer Park? (Please tick box)

Yes with friends		Yes with family	
Yes on my own		No	

2. If yes, what do you do there? (Please tick boxes)

Walk		Bowl		Meet friends	
Tennis		Dog walk		Attend event e.g Bands in Park, bird feeder making	

Other (please give details)

3. Which of the following activities would you like to see in Spencer Park? (Please tick boxes)

Climbing and scrambling		Swinging	
Imaginary play		Sliding and balancing	

Other (please give details)

4. Which **three** features do you think should be definitely included in Small Spencer Park? (Please tick only 3 boxes)

Yew hedge maze		Wooden stepping stones		Enclosed hedge or fence	
Swings		Slide		Painted play area e.g hopscotch	
Logs		Elevated house		Seating	
Shelter		Sensory garden		Roundabout	

5. Any other ideas for small Spencer Park?

Spencer Park Recreation Ground (big park)

As part of the future plans of the Friends of Spencer Park and Recreation Ground we would like to develop Spencer Recreation Ground for over 8s if we can obtain funding.

6. Do you already use Spencer Recreation Ground? (Please tick boxes)

Yes with friends		Yes with family	
Yes on my own		No	

7. If yes, what do you do there? (Please tick boxes)

Walk or run		Walk dog		Football	
Meet friends		Basketball		Swing	

Other (please give details)

8. Which three of the following activities would you like to see in Spencer Recreation Ground? (Please tick only 3 boxes)

Climbing and scrambling		Swinging and gliding	
Football pitch		Fitness circuit and equipment	
A games area with a hard surface for playing ball games on. See picture		Shelter and seating	

9. Any other ideas for Spencer Recreation Ground?

Please tell us about yourself

It would help if you would complete the details below. You are under no obligation to do so if you do not wish. We will only use the information to analyse this survey. (Please tick boxes)

1. Please tell us how old you are or the age of the person you are replying for?

Under 10 years		10 — 18 years		19 — 34 years	
35 — 49 years		50 — 64 years		65 and over	

2. Are you?

Male		Female	
------	--	--------	--

3. What is your ethnicity?

White British		Asian Pakistani	
White Irish		Asian Bangladeshi	
White Gypsy or Irish Traveller		Chinese	
Any other White background		Any other Asian background	
Mixed White and Black Caribbean		Black African	
Mixed White and Black African		Black Caribbean	
Mixed White and Asian		Any other Black/ African/ Caribbean/ background	
Any other Mixed/ multiple ethnic background		Arab	
Asian Indian		Any other ethnic group	

4. Do you consider yourself to have a disability?

Yes		No	
-----	--	----	--

5. What is your postal code? _____

If you would like to be entered in our prize draw for a £25 gift voucher please fill in your name and contact telephone number or email.

Name: _____

Telephone number: _____

Email: _____

This will only be used if you win the prize and will not be used for any other reason unless you want to be kept up to date with our activities. If you do please tick box?

Thank you for taking the time to fill in this survey

Please can you return it to the ECHO box in Earlsdon Library or to the office in Spencer Park by 17 May 2013